

## Adjustment:

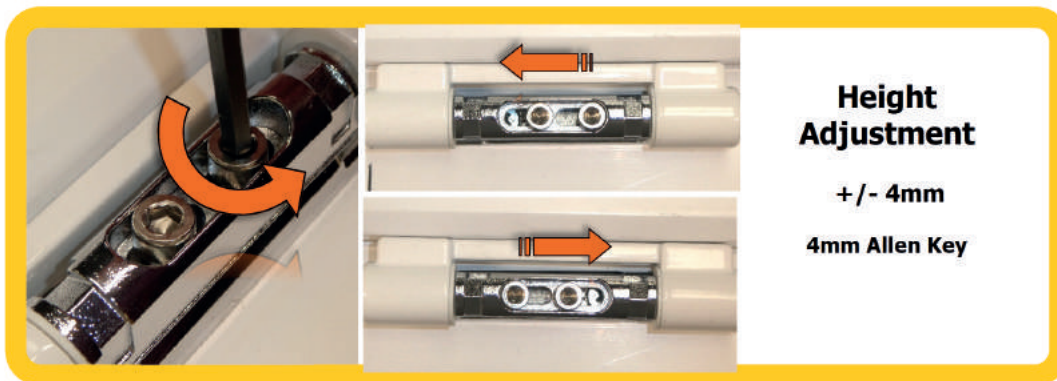

Lateral Adjustment: (Note Lateral and height adjustment can be made simultaneously)  
Slacken off both M5 Cap Head Screws **on all hinges** (and ensure they are re tightened after adjustment)  
The Door can now be moved one way or the other about the nominal position



Lateral Adjustment: (Note Lateral and height adjustment can be made simultaneously)  
Slacken off both M5 Cap Head Screws **on all hinges** (and ensure they are re tightened after adjustment)  
The Door can now be moved up or down about the nominal position